

Heavy Duty Actuators

The FA-3300 heavy duty series provides floating or proportional control and can be mounted with VG8000 flanged valves.

Features

- 24 VAC and 230 VAC power supply
- Floating and Proportional control
- Manual override
- Special clamp coupler
- Uses synchronous motor with calibrated pressure limit switches

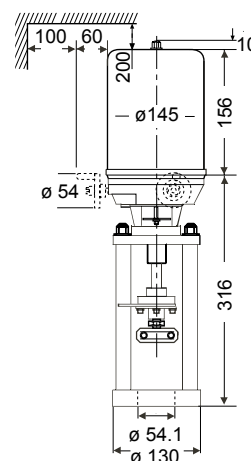

Dimensions in mm

Ordering Codes	Supply Voltage (50/60Hz)	Action Control	Force	Stroke	Full Stroke Time	Protection Class	Power Consumption	Accessories Factory mounted				
FA-3300-7416	24 VAC	Floating	6000 N	42 mm (max 45)	150 s	IP 65	37 VA	none				
FA-3303-7416								2 aux switches and 2 KΩ pot				
FA-3304-7416		135 Ω pot										
FA-3341-7416		2 aux switches										
FA-3300-7411	230 VAC	Floating					6000 N	42 mm (max 45)	150 s	IP 65	37 VA	none
FA-3303-7411												2 aux switches and 2 KΩ pot
FA-3304-7411		135 Ω pot										
FA-3341-7411		2 aux switches										